

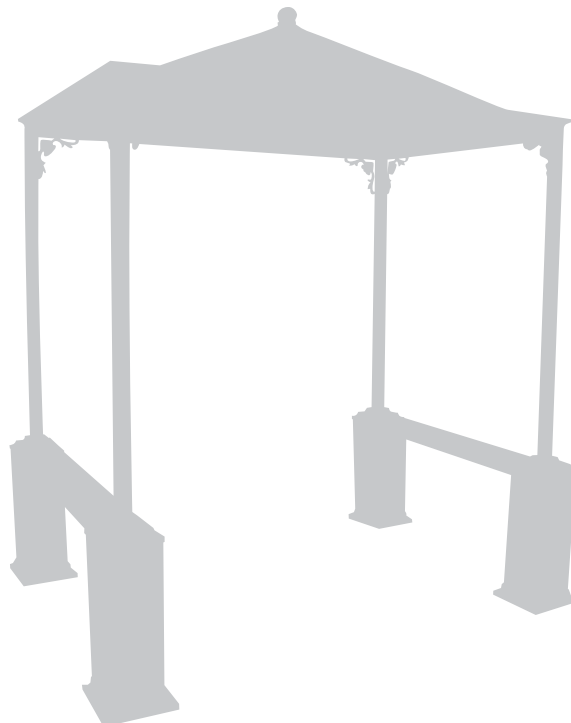

10' x 10'

SPARTA
GAZEBO 

I N S T R U C T I O N M A N U A L



CARAVAN[®]
instant
canopies

14600 Alondra Blvd.

La Mirada, CA 90638

877-9-CANOPY

714-367-3000

Fax 714-367-3050

www.caravancanopy.com

ASSEMBLY DIAGRAM & PARTS LIST

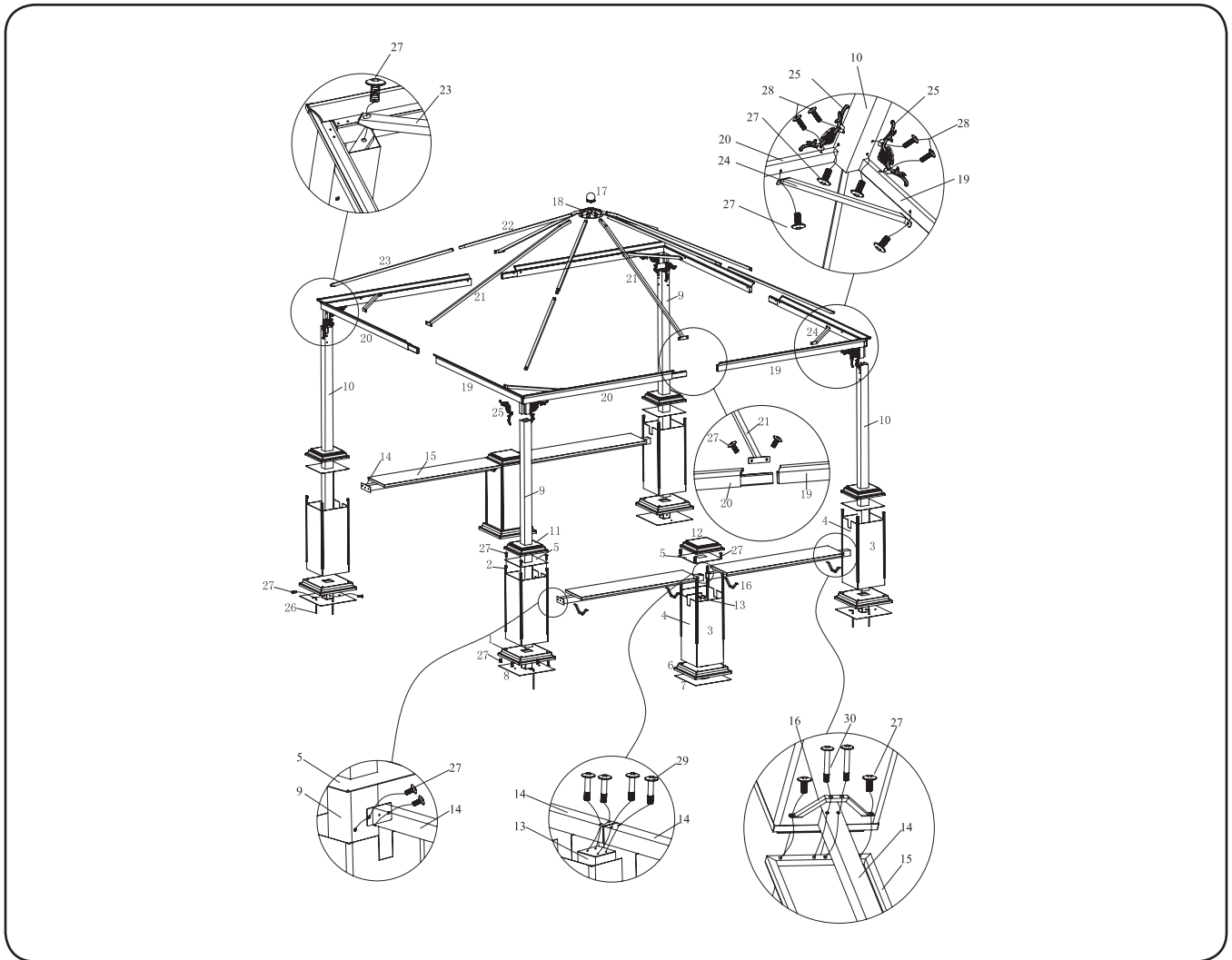

Part	Name	Image	Qty
1	Top Post Cover		4
2	Base Bracket		24
3	Corner Base Plate		16
4	Inner Base Plate		8
5	Post Cover Plate		6
6	Middle Top Post Cover		2
7	Middle Bottom Plate		2
8	Bottom Plate		4
9	Structure Post - L		2
10	Structure Post - R		2
11	Base Post Cover		4
12	Seat Plate Frame		2
13	Base Post		2
14	Middle Structure Bar		4
15	Seat Plate		4
16	Seat Bracket		8

Part	Name	Image	Qty
17	Peak Crown		1
18	Ceiling Peak		1
19	Ceiling Frame Bar - L		4
20	Ceiling Frame Bar - R		4
21	Ceiling Support Bar		4
22	Ceiling Frame - Outer		4
23	Ceiling Frame - Inner		4
24	Corner Bracket		4
25	Decorative Bracket		8
26	Ground Stake		16
27	Small Screw		112
28	Medium Screw		16
29	Extended Short Screw		8
30	Extended Long Screw		16
31	Fabric Cover		1
32	Allen Wrench		1

SPARTA GAZEBO SET UP INSTRUCTIONS

Warning! Please Read - Immediately!

- This Gazebo is manufactured to provide maximum protection from the sun.
- Do not leave Gazebo top on in any wind, rain, snow or inclement weather conditions.
- Do not use open flame under or near Gazebo.
- Do not hang materials or objects on or from Gazebo.

Tools Needed To Assemble:

- Cordless Drill/Screwdriver
- Ladders (2)

Important:

- Do not remove numbered stickers until set up is complete.
- Requires a minimum of 3 people to assist with assembly

BASE & SEAT ASSEMBLY

Step #1

Insert bottom plates – parts #7 & #8 – into posts – parts #9, 10, 13 - with small screws and secure (pic. #1). Repeat process for all posts.



Step #2

Place top post cover – part #1 – over posts – parts #9, 10, 13 (pic #2A). Attach base brackets – part #2 and secure (pic #2B) with small screws.

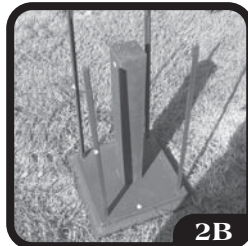

Step #3

Slide corner base plates and inner base plates – part #3 & #4 – into each base brackets covering the base post. Repeat this process for all posts (pic #3).



Step #4

Lift-up structure posts (4) – parts #9 & 10 – and insert base post cover – part #11 – onto structure post (pic #4A). Then insert post cover plate – part #5 – onto structure post



(pic #4B). Repeat this process for all posts. Secure all parts with medium screws.

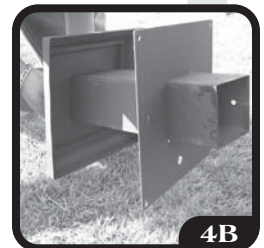

Step #5

Assemble entire lower base post section onto structure post (pic #5A) – base plates will need to be removed and reassembled if necessary (pic #5B). Secure base posts with small screws (pic #5C).



Hold post cover plate and base post cover - parts #5 & 11, while inserting corner base plates - part #3 (pic #5D). Repeat process for all corners.



Place post cover plate onto face plates (pic #5E). Repeat this process for all posts. Secure all parts with small screws.

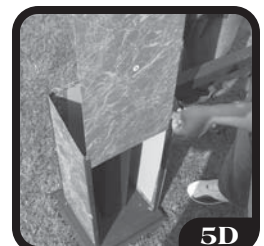

CONTINUED ON NEXT PAGE...>

BASE & SEAT ASSEMBLY



5E

Step #6

Attach middle structure bar - part # 14 to base post - part # 13 (2). Secure with extended short screws (pic # 6). Repeat this process for both sides.



6

Step #7

Place post cover plate - part # 5 - onto middle posts (pic #7A). Place seat plate frame - part # 12 - onto seat plate cap (pic #7B) and secure.



7A

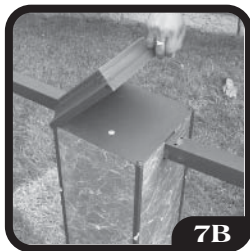

7B

Step #8

Place seat plates (4) - part # 15 - onto mid structure bars (pic #8A) and attach to frame. Secure with small screws and extended long screws. Place seat bracket - part #16 - underneath seat and secure with small screws (pic #8B).



8A



8B

ROOF & FRAME ASSEMBLY

Step #1

Slide and insert ceiling frame bars - parts #19 & 20 into each other (pic #1A) and secure. Insert ceiling frame bars into structure posts - parts # 9 & 10 (pic #1B). Repeat this process for all posts. Secure all parts with small screws (pic #1C).

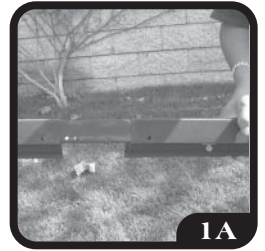

1A



1B



1C

Step #2

Place decorative brackets (8) - part #25 - into each corner of the ceiling frame structure and secure with medium screws (pic #2).



2

Step #3

Align corner brackets - part # 24 - into each frame corner and secure with small screws (pic #3).



3

CONTINUED ON NEXT PAGE...>

ROOF & FRAME ASSEMBLY

Step #4

Attach ceiling frame pieces - parts # 22 & 23 - (pic #4A) together and the bars formed from part # 22 & 23 into ceiling peak - part # 18. Attach ceiling support bars (4) - part # 21 (pic #4B). Secure push pins into frame structure (pic #4C).

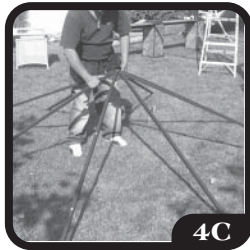
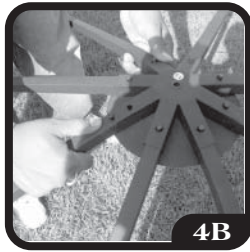
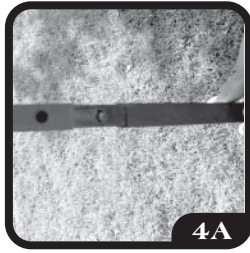

Step #5

Lift the frame structure up onto base and seat assembly (pic #5A) and secure push pins in each corner of the ceiling frame base (pic #5B).



Step #6

Tighten and secure all small screws into the entire ceiling frame and support bars (pic #6).



Step #7

Drape the fabric cover - part # 31 over the ceiling frame structure (pic #7) and secure in the four corners of the frame.



Step #8

Place ceiling peak crown - part # 17 - through the top opening of the ceiling fabric and attached to ceiling frame peak (pic #8).



Step #9

Secure ceiling fabric to frame buttons by twisting in place (pic #9).



Step #10

Your Sparta Gazebo is now assembled for your enjoyment. (pic #10).



SPARTA

GAZEBO



CARAVAN® 1-YEAR LIMITED WARRANTY

Caravan® Canopy Int'l warrants that each part of this product and the product itself will be free from defects in material and workmanship for twelve (12) months from date of purchase. This warranty is void if: (A) Product is used under other than normal use and maintenance conditions. (B) Product is modified or altered. (C) Product is subject to abuse or neglect. (D) Product damage is accidental or deliberate or caused by rain, wind or other forces of nature. (E) Product use does not conform to product instructions. (F) Product is repaired by someone other than Caravan® Canopy Int'l or its authorized representative.

The manufacturer's obligation is limited to replacing or repairing such defects during the warranty period at no charge.

If service is required, do not return the product to the store. Please contact Caravan® Canopy Int'l for specific shipping instructions before returning any part. All shipping costs must be pre-paid. A purchase receipt or other proof of purchase is required before warranty service is rendered. Caravan® Canopy Int'l will not be responsible for any products damaged in transit.

For a warranty claim call 877-9-CANOPY. Most service problems are resolved by replacing a broken or defective part. If this is not the case, we will give you instructions for returning the product. Return products to: Caravan® Canopy International Inc., 14600 Alondra Blvd., La Mirada, CA 90638 USA

After inspection, warranted products will be returned at no cost. If it is determined that products are not a warranty issue, it is the customer's responsibility to pay for repair and/or replacement parts and return shipping costs. If a problem with your canopy develops after the warranty period, please contact Caravan® Canopy Int'l for service. 877-9-CANOPY.

Under no circumstances will the retail customer, user, authorized representative or other person be entitled to any direct, special, indirect, consequential or exemplary damages for breach of contract or otherwise. Under no circumstances will any person be entitled to a sum greater than purchase price of the malfunctioning part.

No Caravan® Canopy Int'l authorized representative or person other than an officer of Caravan® Canopy Int'l may extend or modify this warranty. There are no other warranties from either Caravan® Canopy Int'l or its representatives which extend the face of this warranty. All other warranties, expressed or implied, including the warranties of merchantability, fitness for a particular purpose and fitness for use are excluded. See www.caravancanopy.com for further details.



14600 Alondra Blvd., La Mirada, CA 90638 USA
877-9-CANOPY • 716-367-3000 • Fax 714-367-3050
www.caravancanopy.com